



FISHBECK, THOMPSON, CARR & HUBER
engineers | scientists | architects | constructors

BUILDING THE FUTURE

INDUSTRIAL SERVICES



EFFICIENT

INDUSTRY



Our economy has rapidly evolved over the past few decades, but the foundation continues to be built on industry. Operational changes, such as safety and technological advances, have led to facilities and sites that are under-utilized or vacant, contaminated, or inefficient for today's market.

To keep pace with these rapid changes, industry leaders need to ensure their facilities and sites are modernized and healthy to maintain efficient production for ever-increasing demand.

FTCH is uniquely qualified as a single-source provider to help you identify and implement solutions that rekindle, grow, or enhance property value, production strength, and research capabilities. You need to be on the forefront of change to keep your market position, and we are here to help.

Our experts provide the environmental, architectural, construction, and engineering services necessary to keep your site viable, your building efficient, and your workforce healthy.



BUILDING THE FUTURE





CASE STUDY

GENERAL DYNAMICS

General Dynamics Land Systems is a leader in designing and producing wheeled and tracked military vehicles for the United States and its allies. To meet the ever-changing needs of the global defense market, General Dynamics Land Systems invited FTCH to design the new Maneuver Collaboration Center (MC2). Our architecture services created a dynamic space used to formulate ideas, develop collaborative design concepts, and ultimately, construct and test design; our engineering services provided the mechanical, electrical, and structural systems necessary to support production and testing.

The success and accolades of the MC2 project brought more opportunities for FTCH work with General Dynamics. We provide environmental services to help with permitting and maintaining occupational health and safety policies. Our team also designed a vehicle testing facility with a massive dynamometer which required special acoustical design and extensive engineering expertise.

Together we have built a relationship based on trust, efficiency, and collaboration. FTCH continues to provide services that help General Dynamics increase troop safety and effectiveness through state-of-the-art products.



INDUSTRIAL SERVICES

MECHANICAL ELECTRICAL STRUCTURAL

ARCHITECTURE

INFRASTRUCTURE

ENVIRONMENTAL

INDUSTRIAL HYGIENE/HEALTH & SAFETY

WATER/WASTEWATER

PERMITTING

CONSTRUCTION

SITE DEVELOPMENT

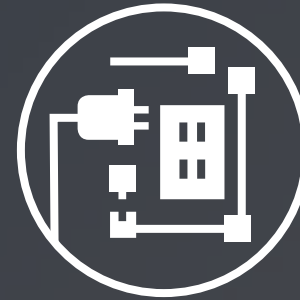

MECHANICAL ELECTRICAL
STRUCTURAL



ARCHITECTURE

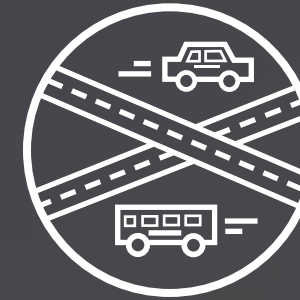

INFRASTRUCTURE



ENVIRONMENTAL



INDUSTRIAL HYGIENE/
HEALTH & SAFETY



WATER/WASTEWATER



PERMITTING



PROJECT MANAGEMENT



SITE DEVELOPMENT

INDUSTRIAL SERVICES



FTCH provides diversified **water resource management** services to reduce the effects of runoff, provide drainage and control flooding, and retain stormwater onsite for the steel mill industry.

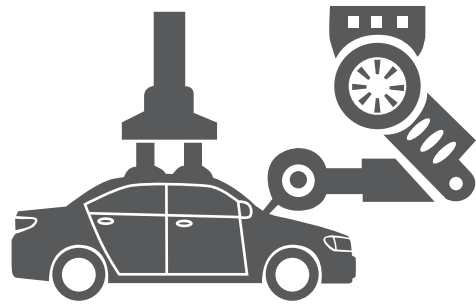

We create adaptive, harmonious **site solutions** for automotive manufacturers and suppliers, through master plans, civil engineering, surveying, and environmental site assessments, to support their changing equipment and production lines.

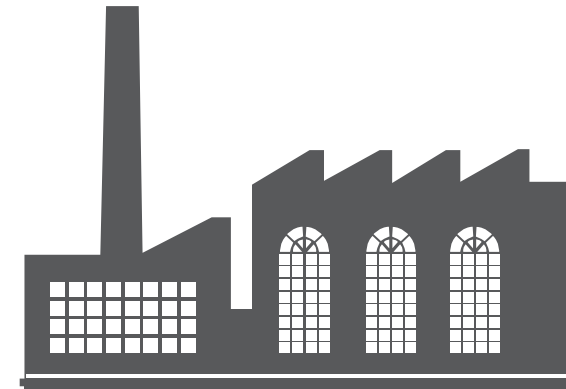

An efficient furniture manufacturing facility requires balance of envelope, heating, cooling, and lighting systems. FTCH produces measurably better building designs through **energy management** solutions and virtual simulations of energy use.



We design the **mechanical, electrical, plumbing, and structural engineering** needed to support production for breweries and beverage producers.

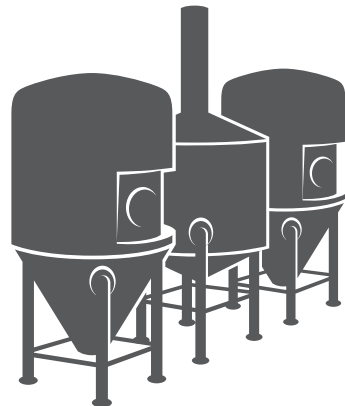

For food producers, we develop **water and wastewater** systems, treatment options for process water, and aerobic/anaerobic digester solutions.

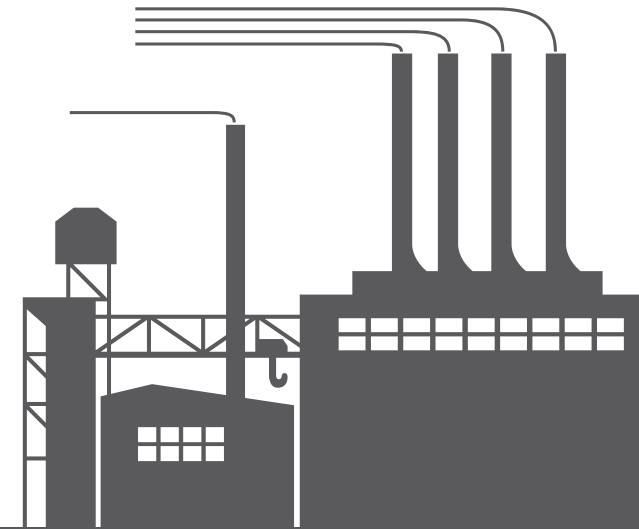

Providing feasible, business-oriented solutions for **industrial hygiene and occupational health and safety**, we anticipate, recognize, evaluate, and develop controls for occupational health hazards in heavy manufacturing environments.

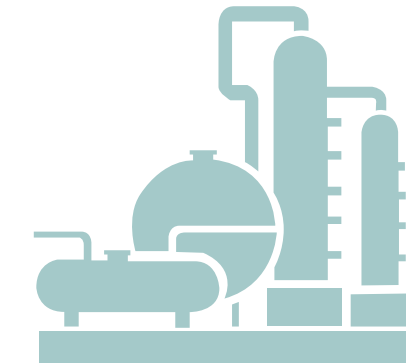

Chemical plants are just one place where **remediation** services may be needed to remove or abate existing underground tanks, chemical spills, or other contaminants.



Designing laboratory space for pharmaceutical plants requires us to work in concert with our **mechanical/electrical/structural** engineers for effective venting, easy connect/disconnects, 100% outside airflow, uninterruptible power supply (UPS), high-performance HVAC, shut-off valves, and more.



Due diligence for expansion will help you mitigate risk, while successful remediation will help recondition a manufacturing site into a viable piece of property once again.



Ever-changing regulations require our expertise to prepare air quality **permits**, compliance **assessments**, air quality **dispersion modeling**, and **solid waste management**.



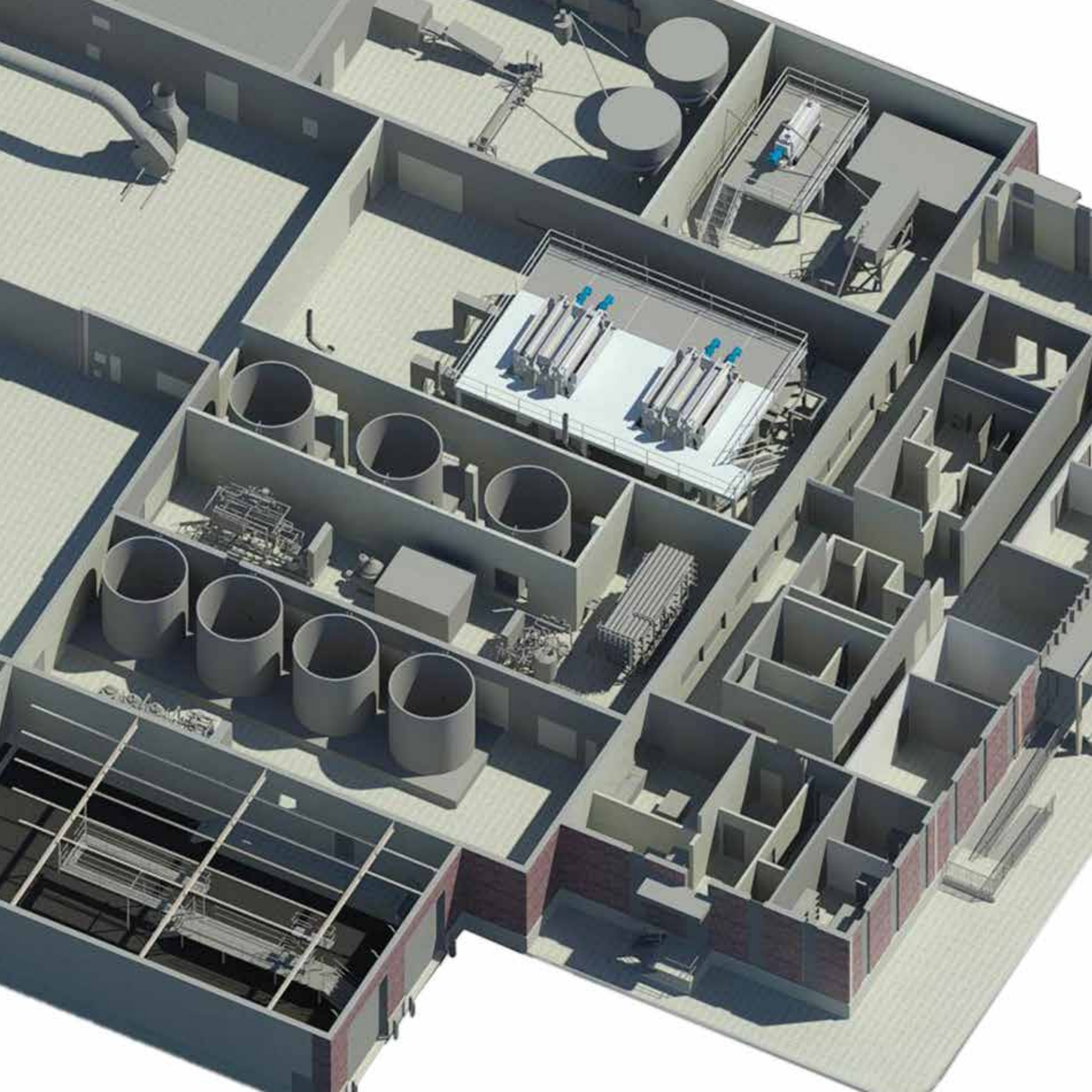

PLACES WE HAVE BEEN

CLIENTS

AEROSPACE
AGRICULTURE
AUTOMOTIVE
BEVERAGE PRODUCERS AND BREWERIES
CHEMICAL
CONTINUOUS MANUFACTURING
DEFENSE AND COMBAT SYSTEMS
FOOD PRODUCERS AND PROCESSORS
FURNITURE
HEAVY MANUFACTURING
MINING AND AGGREGATES
OIL AND GAS
PHARMACEUTICAL
POWER GENERATION
PULP AND PAPER
STEEL MILLS AND FOUNDRIES
WOOD AND FORESTRY PRODUCTS

INSPIRING RESULTS